

VASUDHAA



Balaji Nagar
South Street

Sundarathammal Colony



Hasthinapuram
Bus Terminus

3rd Main Road

Mamiyar
Mess Foods

Abirami Kalyana
Mandapam

Purushothaman Nagar 3rd Cross Street

Govt. School

Devarajan Street

R.P. Road

KL Mahal

Muthumari
Amman Koil



Sankar Constructions

Plot No.32, First Floor, Hariharan Towers, R.P. Road
Chromepet, Chennai - 600044.

Mob. : 98416 59929 / 98416 59930

Email : sankarconstructions2006@gmail.com

Web : www.sankarconstructions.in



Sankar Constructions



Vasudhaa



Plot No.46, Balaji Nagar South Street,
Chromepet, Chennai - 600044.



GROUND FLOOR PLAN



FIRST FLOOR PLAN



SECOND & THIRD FLOOR PLAN

S.No.	FLAT	AREA	UDS
1.	F1	1710 Sq.ft.	777 Sq.ft.
2.	S1	843 Sq.ft.	383 Sq.ft.
3.	S2	867 Sq.ft.	394 Sq.ft.
4.	T1	843 Sq.ft.	383 Sq.ft.
5.	T2	867 Sq.ft.	394 Sq.ft.

PAYMENT

AT THE TIME OF BOOKING	Rs.1,00,000
AT THE TIME OF AGREEMENT (WITHIN 10 DAYS FROM THE DATE OF BOOKING)	20%
AT THE TIME OF REGISTRATION (WITHIN 20 DAYS FROM THE DATE OF BOOKING)	45%
ON COMPLETION OF FOUNDATION WORK	10%
ON COMPLETION OF Silt Floor ROOF SLAB	10%
ON COMPLETION OF BRICK WORK	5%
ON COMPLETION OF PLASTERING WORK	5%
AT THE TIME OF HANDING OVER	BALANCE

AMENITIES :

- WITH LIFT UPTO TERRACE
- INDIVIDUAL COVERED CARPARKING
- 24 HOURS POWER BACKUP
- AS PER VAASTHU
- CCTV CAMERA
- AUTOMATIC WATER TANK CONTROL LEVELLER
- VIDEO DOOR PHONE

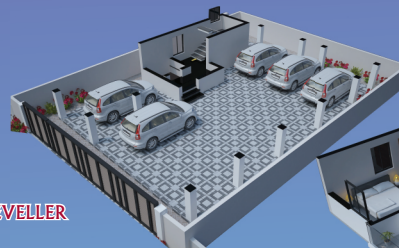

GROUND FLOOR PLAN



FIRST FLOOR PLAN



SECOND & THIRD FLOOR PLAN

SPECIFICATIONS

STRUCTURE : RCC framed Structure

JOINERY : Main Door - Teak Wood frame and Panelled Shutter
Other Door - Modular flush door with teak wood frames
Windows UPVC Frames Open (or) glazed shutter and M.S. Grills

FLOORING : 2x4 Johnson Vitrified tiles over a layer of cement mortar

KITCHEN : Glazed tiles, cladding 4 feet height over granite cooky platform and stainless steel sink.

BATHROOM : (Jaquar tap fittings) Ceramic flooring and concept glazed tiles cladding upto 7'0" height. Single Piece Western Closet (Whitecolour, Parry ware Cascade equivalent brand) IWC for other toilet in each flat. Hot and Cold Water plumbing arrangements using Jaquar tap Fittings. Concealed line in CPVC and PVC for open line. One colour wash basin 20"x16" in common area and other in attached bathroom.



PREFERRED BANKS



Sankar Constructions

Plot No.32, First Floor, Hariharan Towers, R.P. Road
Chromepet, Chennai - 600044.

Mob. : 98416 59929 / 98416 59930

Email : sankarconstructions2006@gmail.com
Web : www.sankarconstructions.in

ELECTRICAL : Concealed 3 phase copper wiring. (ISI approved) brand) A/C point in Master Bed Room and Geyser point in attached toilet. Provision for exhaust fan in Kitchen. Anchor Switches.

TELEPHONE / T.V. POINTS : In living Room.

PLUMBING WORKS : Open and concealed soil lines in PVC adequate number of Sewage inspection Chambers.

WATER SUPPLY : A Borewell to tap ground water. Arrangement for pumping water to overhead tank will be provided.

PAINTING : Emulsion paint for internal over a coat of putty exterior emulsion for external walls and synthetic enamel paint for doors and windows.

CUPBOARD AND LOFTS : One Loft and one cupboard with cuddappah shelves in each bedroom and kitchen.

LIFTS : Lift will be provided connecting ground floor to Terrace